

# Regal A3 GISELA

Art. 1091

Alles  
aus  
Papier

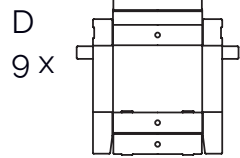
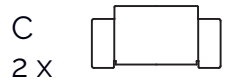
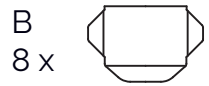
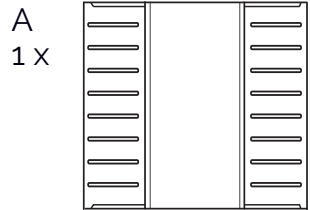

Bitte achten Sie beim Aufbau auf die Innen- und Außenseite.  
Die Innenseite hat immer einzelne, starke Rill-Linien, die Außenseite zwei schwächere.

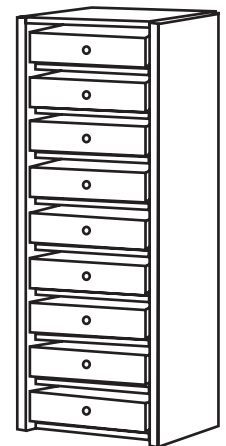
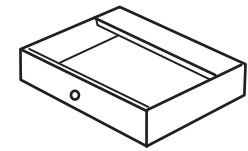
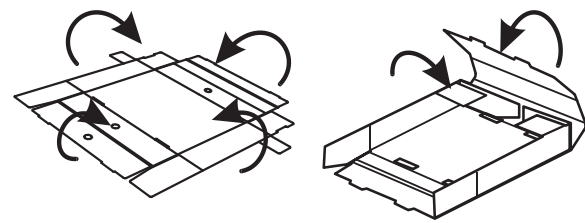
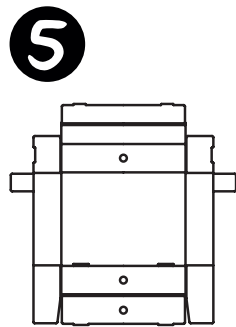
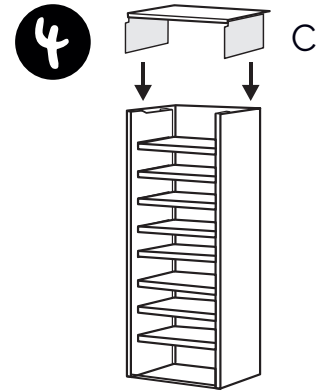
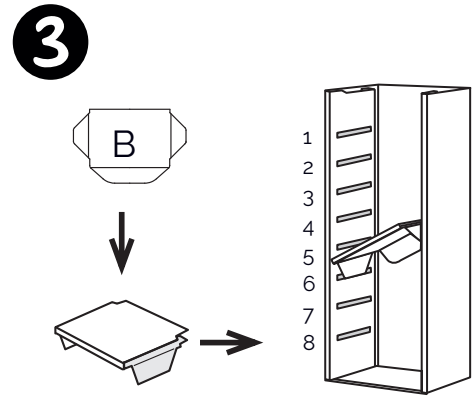
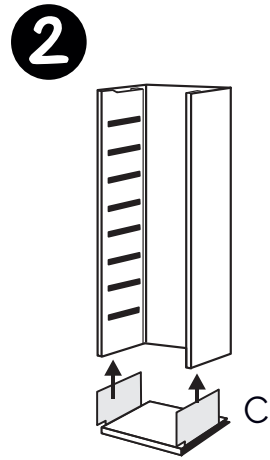
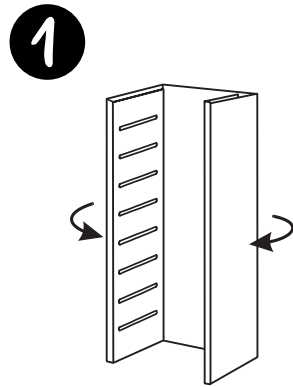

## VIDEO!

Ein Video zum Aufbau  
finden Sie auf YouTube:

